



Accessing Mediat Through the My Campus Portal

1. Open a web browser.
2. Go to your My Campus portal at <https://mycampus.uvi.edu/>
3. Sign in with your 900 number and password.

The image shows the login page of the University of the Virgin Islands My Campus Portal. It features the university's logo and name at the top. Below, it says "Welcome!" and "Enter your details below". There is a "Username" input field with the placeholder text "900XXXXXX". Below the input field is a link that says "Forgot your username?". At the bottom right is a blue "Sign in" button.

4. Click on the "Quick Launch" menu. This is the keyhole icon
 - a. On a desktop computer it can be found on the left side of the page.

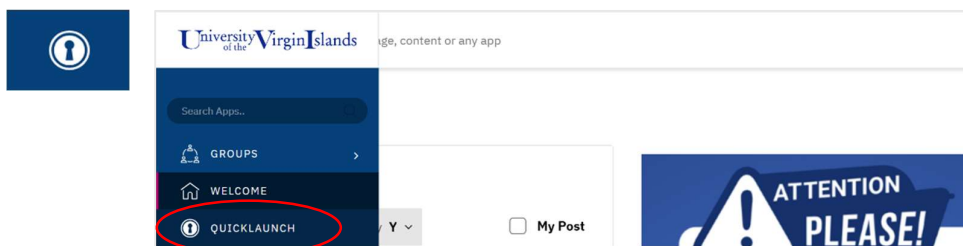

- b. On a mobile device, the keyhole icon can be found here:

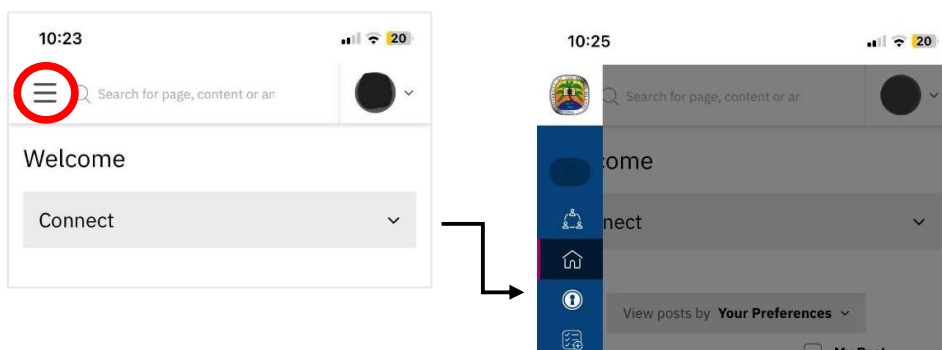

5. Scroll down and click on the 'Health Hub' icon.
6. You are now logged in to the Mediat Portal.

